



# Illustrated Parts Manual

**Lighting Tower  
Model**

**JLG LT<sup>3</sup>**

**1001309468**

**Revision C**

**January 15, 2024**



JLG LT<sup>3</sup>

## ILLUSTRATED PARTS MANUAL

CONTENTS	PAGE
Chassis Assembly	3
Fuel Tank & Bunding	5
Battery & Power pack Assembly	7
Engine & Alternator Assembly	9
Doors & Panels Assembly	15
Mast Assembly	17
Mast Section 1	19
Mast Section 2	21
Mast Section 3	22
Mast Section 4	25
Mast Section 5	27
Mast Section 6	27
Light Head	31
Electrical Assembly	34
Decal & Miscellaneous Parts	35
Recommended Spares	37

### REFERENCE MANUALS

LT <sup>3</sup> Operation & Safety Manual	1001309466
LT <sup>3</sup> Service & Maintenance Manual	1001309467



**FUEL TANK & BUNDING ASSEMBLY**

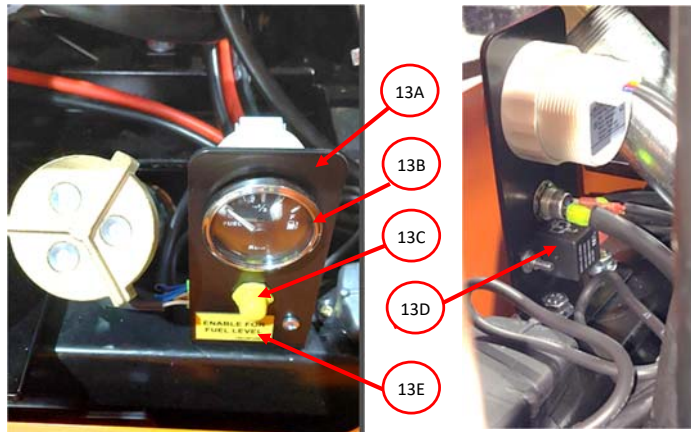
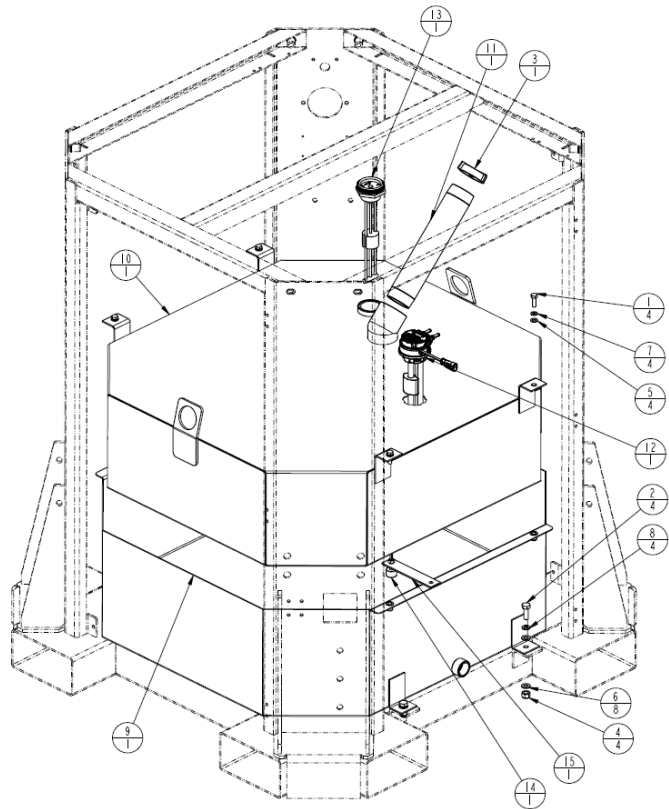

SEQ.#	ITEM NO.	DESCRIPTION	QTY
1	0760812	HEX HEAD BOLT, M8 X 25 CLASS 8.8	4
2	0761014	HEX HEAD BOLT, M10 X 30 CLASS 8.8	4
3	1120314	CAP, FUEL TANK FILLER	1
4	3291005	HEX LOCK NUT, M10 X 1.5 CLASS 10	4
5	4811900	WASHER, 8 mm	4
6	4812000	WASHER, 10 mm	8
7	4831900	LOCK WASHER, SPRING 8 mm	4
8	4832000	LOCK WASHER, SPRING 10 mm	4
9	1001278691	FRAME, BUNDING	1
10	1001278694	TANK, WELDMENT FUEL (MUST ORDER 13A-13E TO SUITS WITH REVISED TANK)	1
11	1001278699	PIPE, FUEL TANK FILLER	1
12	1001278808	SENSOR, FUEL GAUGE	1
13	1001282606	GAUGE, FUEL MECHANICAL 10" (OPTION) (PRIOR S/N:LT30000051)	1
13A	1001291297	BRACKET, ANALOG GAUGE MOUNT (OPTION) (FROM S/N LT30000051)	1
13B	1001291200	GAUGE, FUEL ANALOG 240-33 OHMS	1
13C	4360387	SWITCH, PUSH BUTTON	1
13D	1001171585	RELAY, 30A 12 VDC SPDT	1
13E	1001291298	SWITCH, PUSH BUTTON	1
14	1001285935	SENSOR, FLOAT SWITCH VERTICAL (OPTION)	1
15	1001287688	BRACKET, FLOAT SWITCH SENSOR (OPTION)	1
16	1001179341	INSERTION RUBBER 50 X 3 mm (NOT SHOWN)	1.7 m

**BATTERY & POWER PACK ASSEMBLY**

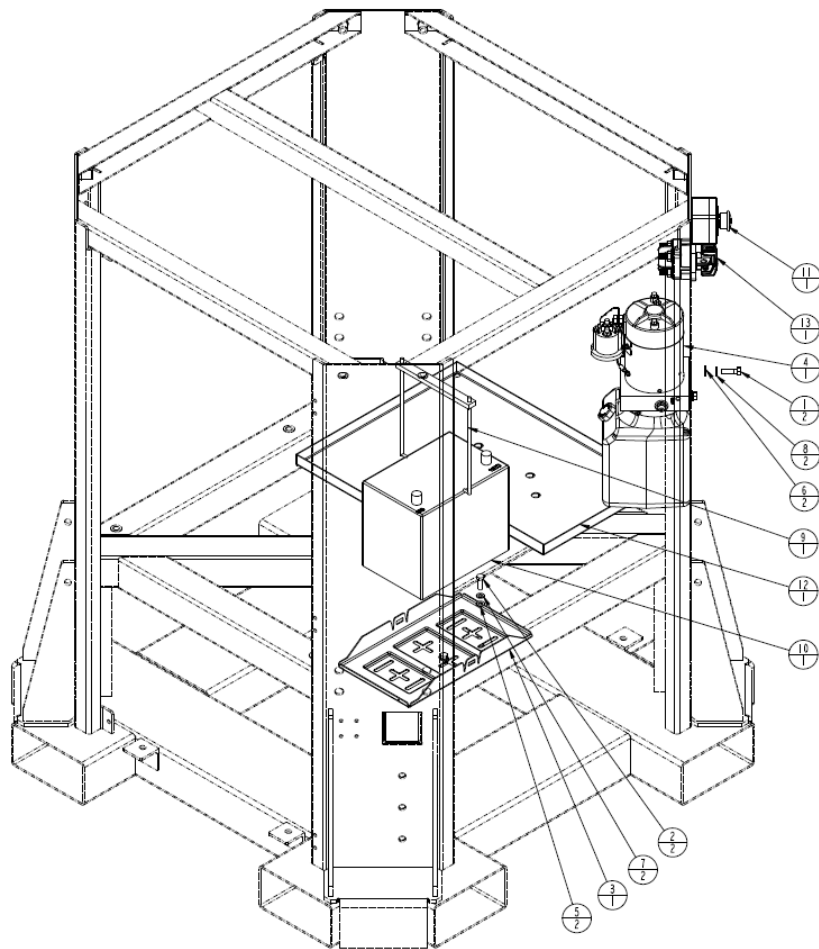

SEQ.#	ITEM NO.	DESCRIPTION	QTY
1	0681610	HEX HEAD BOLT, 3/8-16 X 1 1/4 GRADE 8	2
2	0760812	HEX HEAD BOLT, M8 X 25 CLASS 8.8	2
3	1731207	BATTERY TRAY	1
4	3600461	POWERPACK, HYDRAULIC C/W TANK & PRESSURE RELIEF VALVE	1
4A	1001246647	SEALING WASHER, 3/8UNC 750 SERIES PRESSURE RELIEF VALVE ADJUSTING SCREW	A/R
5	4811900	WASHER, 8 mm	2
6	4812000	WASHER, 10 mm	2
7	4831900	LOCK WASHER, SPRING 8 mm	2
8	4832000	LOCK WASHER, SPRING 10 mm	2
9	1001160992	CLAMP, BATTERY HOLD DOWN	1
10	1001160993	BATTERY, 12 V	1
11	1001204848	EMERGENCY STOP	1
12	1001278898	TRAY, MAST BUNDING	1
13	1001287833	SWITCH, BATTERY ISOLATOR	1
14	1001278927	CABLE, KIT BATTERY (NOT SHOWN)	1

**ENGINE & ALTERNATOR ASSEMBLY**

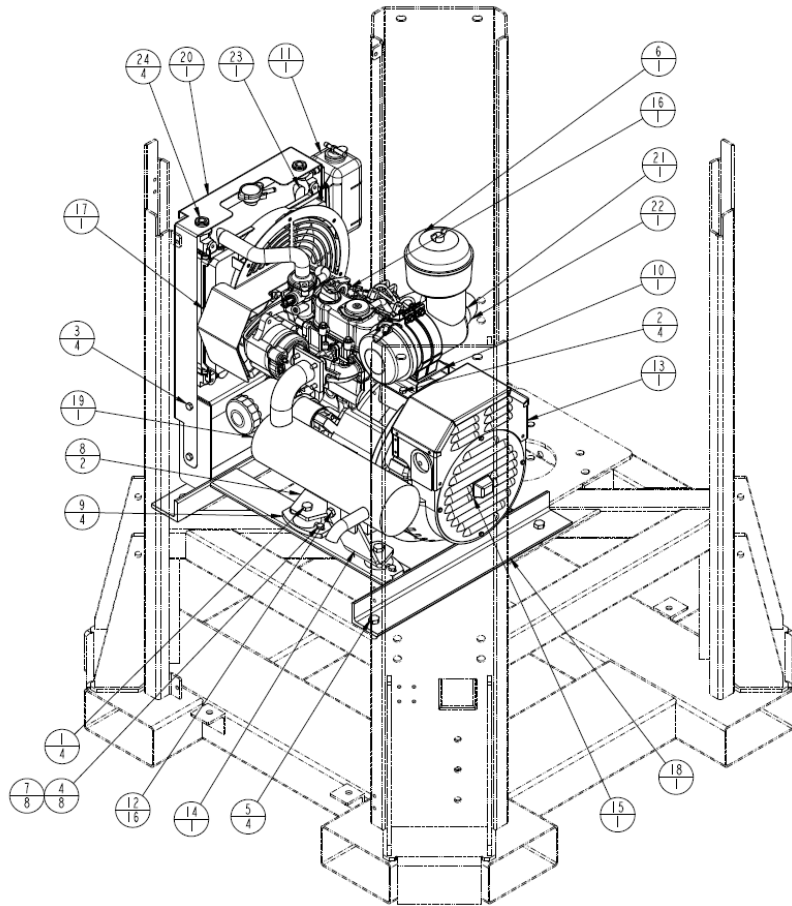

13A 13B 13C

SEQ.#	ITEM NO.	DESCRIPTION	QTY
1	0711215	HEX HEAD BOLT, M12 X 35 CLASS 10.9	4
2	0760810	HEX HEAD BOLT, M8 X 20 CLASS 8.8	4
3	0760812	HEX HEAD BOLT, M8 X 25 CLASS 8.8	4
4	0760814	HEX HEAD BOLT, M8 X 30 CLASS 8.8	8
-	4811900	WASHER, 8 mm	24
-	4831900	LOCKWASHER, SPRING 8 mm	16
5	0761216	HEX HEAD BOLT, M12 X 40 CLASS 10.9	4
-	4812100	WASHER, 12 mm	8
-	4832100	LOCKWASHER, SPRING 12 mm	8
6	1001118022	FILTER, PRE-CLEANER-BOWL (OPTION)	1
7	3290805	HEX LOCK NUT, M8 X 1.25 CLASS 8	8
8	1001205306	BRACKET, KUBOTA Z482 ENGINE LEG	2
9	1001205894	ENGINE MOUNT, GPM7FS-12B ISOLATOR	4
10	1001206704	BRACKET, Z482 AIR CLEANER MOUNT	1
11	1001212181	CONTAINER, Z482 COOLANT BOTTLE	1
12	1001219876	HEX HEAD SCREW, M10 X 1.25P-30 CLASS 8.8	8
13	1001254219	GENERATOR, PMG, 48V 1500 RPM	1
13A	1001306076	CAPACITOR, PMG FOR 1500 RPM	-
13B	1001303798	HOLDER, ISO CH20 H.25 F.M6 RED	-
13C	1001303799	HOLDER, ISO CH20 H.25 F.M6 BLK	-
	1001306433	RECTIFIER BRIDGE, 90A 3PH FOR 1500 RPM PMG	-
14	1001255861	BRACKET, Z482EG ENGINE LEFT	1
15	1001255862	BRACKET, Z482EG ENGINE RIGHT (NOT SHOWN)	1
16	1001256289	ENGINE, KUBOTA Z482 ELEC-GOV	1
17	1001272031	COVER, FAN-BELT KU Z482 ENGINE	1
18	1001278780	FRAME, ENGINE GENSET	1
19	1001278803	MUFFLER, STANDARD	1
20	1001288270	BRACKET, RADIATOR HOLD	1
21	1001212174	FILTER, AIR KUBOTA Z482	1
22	1001206201	HOSE, KUBOTA Z482 AIR CLEANER	1
23	1001265319	RADIATOR, Z482 ELE-GOV ENGINE	1
24	1001265318	MOUNT, RUBBER BUSH RADIATOR	4
25	1001278928	HARNESS, ENGINE MAIN (NOT SHOWN)	1

JLG LT<sup>3</sup>

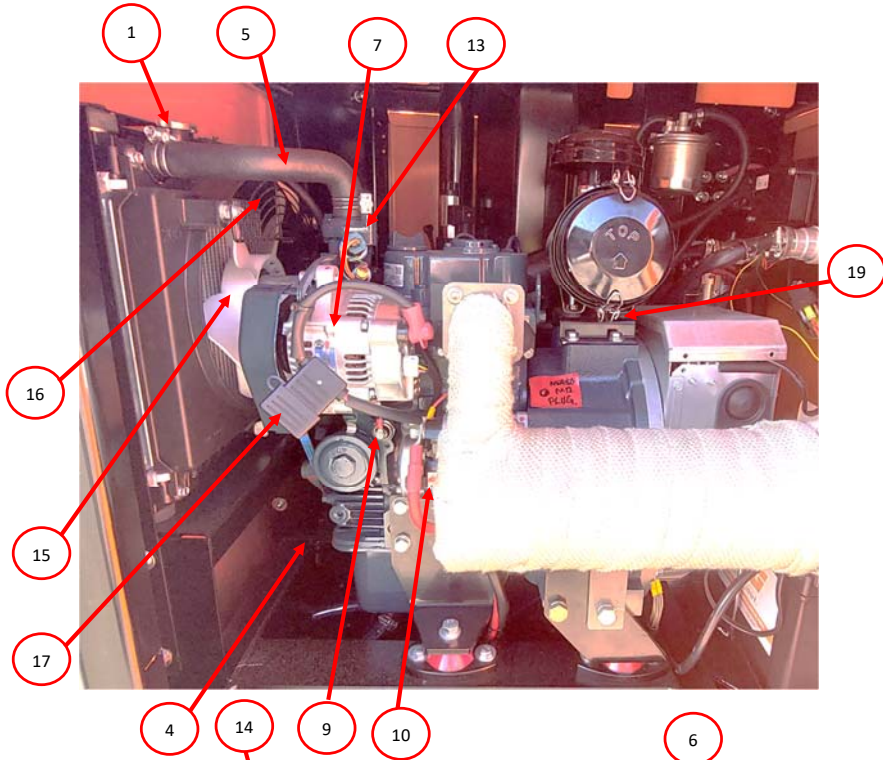

JLG LT<sup>3</sup>

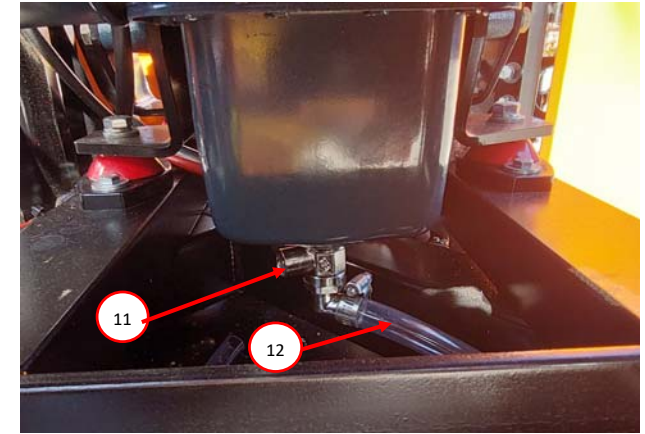
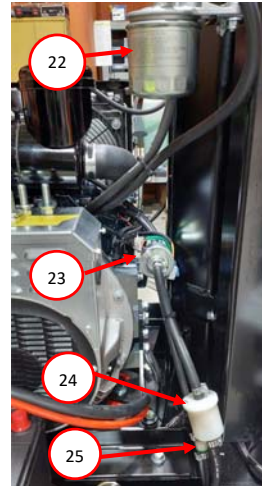

SEQ.#	ITEM NO.	DESCRIPTION	QTY
1	1001258616	CAP, RADIATOR KUBOTA Z482 EG	1
2	1001258717	SUPPORT, DIPSTICK GUIDE KUBOTA	1
3	1001258718	GAUGE, DIPSTICK ENGINE KUBOTA	1
4	1001265317	HOSE, RADIATOR OUTLET (BOTTOM)	1
5	1001265320	HOSE, RADIATOR INLET (TOP)	1
6	1001265321	FAN, BELT KUBOTA Z482 EG ENGINE	1
7	1001265351	ENGINE, ALTERNATOR Z482 EG	1
8	1001265352	FILTER, OIL Z482 EG ENGINE	1
9	70000297	OIL PRESSURE SENDER	1
10	1001265354	ASSY STARTER	1
11	1001205052	VALVE, EZ7BL M22X1.5P L-NIPPLE	1
12	1001207320	HOSE, CLEAR VINYL 5/8" DIA.	0.9 m
13	70004853	ASSY, WATER PUMP	1
	70004854	GASKET, WATER PUMP (NOT SHOWN)	1
	7017900	COCK, WATER DRAIN ASSY (NOT SHOWN)	1
14	1001229321	BRACKET, Z482 AIR CLEANER	1
15	1001265356	FAN, RADIATOR Z482 EG ENGINE	1
16	1001269228	SHIELD, ENGINE FAN Z482 EG KU	1
17	7346000126	FUSE HOLDER 12 GA INLINE 30 AMP	1
18	8229245	FUSE, 30 AMP	1
19	1001287689	GROMMET,5/16 ID X 17/32 OD	4
20	1001259142	INDICATOR, RESTRICTION X002250 (OPTION)	1
21	1001259420	MOUNT, AIR RESTRICT INDICATOR (OPTION)	1
22	1001181346	FUEL FILTER	1
23	1001265403	ELECTRIC FUEL PUMP	1
24	7017992	FILTER FUEL IN LINE	1
25	1001265717	VALVE, FUEL ONE WAY Z482EG KU	1

**Z482 ELECTRONIC GOVERNOR ENGINE HARNESS CONNECTORS (NOT SHOWN)**

**ENGINE SPEED SENSOR (1001297172)**

SEQ.#	ITEM NO.	DESCRIPTION	QTY
01	1001259285	CONNECTOR, FEMALE 3WAY SPEED SENSOR	1
02	1001259291	TERMINAL, FEMALE TE1188 SPEED SENSOR	3
03	1001259312	SEAL GREEN CA1082	3

**COOLANT TEMP SENSOR**

SEQ.#	ITEM NO.	DESCRIPTION	QTY
01	1001259274	CONNECTOR, FEMALE 2WAY TEMP SENSOR	1
02	1001259287	TERMINAL, FEMALE TE1176 TEMP SENSOR	2
03	1001259313	SEAL BROWN CA1086	2

**ACTUATOR SOLENOID (KU1E41160013)**

SEQ.#	ITEM NO.	DESCRIPTION	QTY
01	1001259275	CONNECTOR, FEMALE 2WAY ACTUATOR	1
02	1001259290	TERMINAL, FEMALE TE1121 SOLENOID	2
03	1001259314	SEAL BLACK CA1085	2

**ECU**

SEQ.#	ITEM NO.	DESCRIPTION	QTY
01	1001259273	CONNECTOR, FEMALE 44WAY ECU	1
02	1001259286	TERMINAL, FEMALE TE1831 ECU	21
03	1001259315	BLANKING PIN BLACK CA1192	23

**BLANK PAGE**

**DOORS AND PANELS ASSEMBLY**

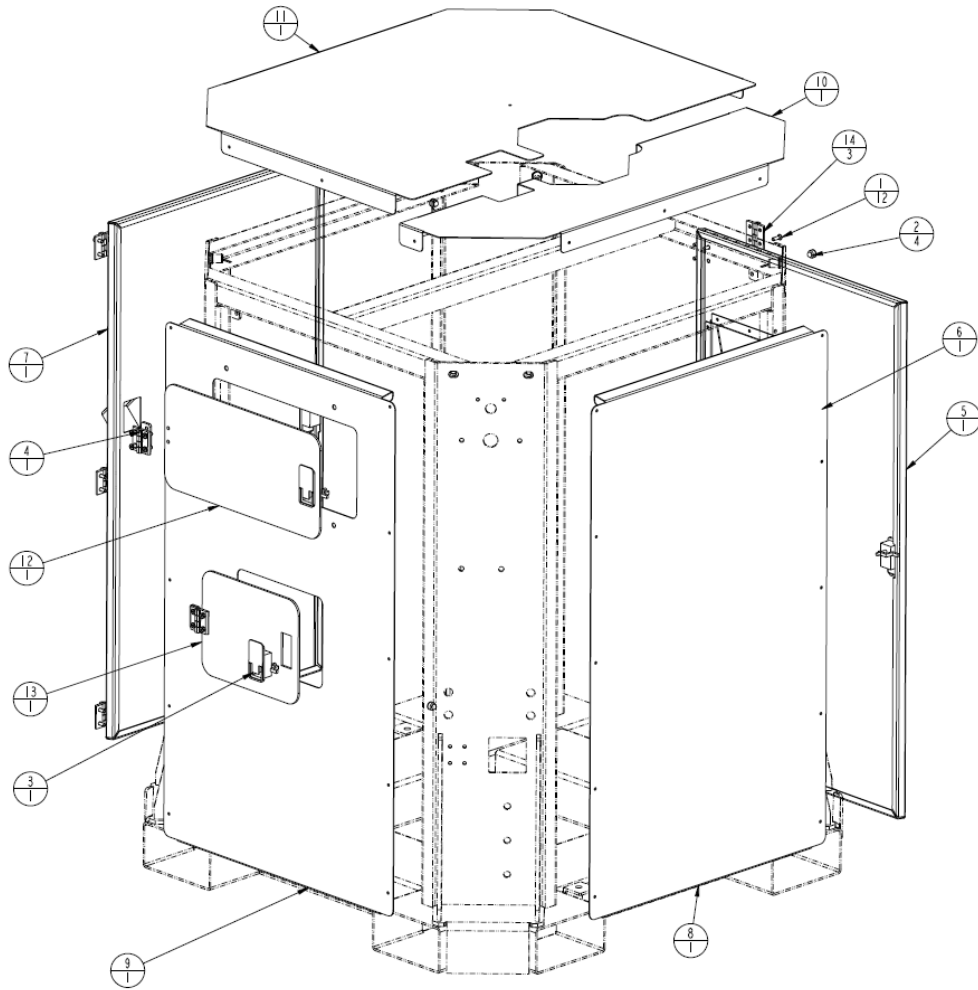

SEQ.#	ITEM NO.	DESCRIPTION	QTY
1	0630576	COUNTER SUNK SCREW M6X20 CLASS 8.8	28
-	3290601	HEX NUT , M6 X 1 CLASS 8	28
-	4811700	WASHER, 6 mm	28
2	0940036	BUMPER, DOOR	4
3	1735660	LATCH, LIFT AND TURN LOCKABLE	4
4	1001210837	BAR, HINGE SPACER	2
5	1001278786	DOOR, RADIATOR SIDE	1
6	1001278788	PANEL, LOUVER	1
7	1001278790	DOOR, MUFFLER SIDE	1
8	1001278792	PANEL, MAST SIDE	1
9	1001278793	PANEL, ASSY CONTROL BOX SIDE	1
10	1001278796	PANEL, ROOF SHORTER	1
11	1001278797	PANEL, ROOF LONGER	1
12	1001278806	PANEL, CONTROL BOX ACCESS	1
13	1001278807	PANEL, FUEL ACCESS	1
14	8006105	JOINT, HINGE	8
11	8990147	HOLDER, MANUAL (NOT SHOWN)	1
20	4360517	SWITCH, PROXIMITY (NOT SHOWN)	2



**MAST ASSEMBLY**

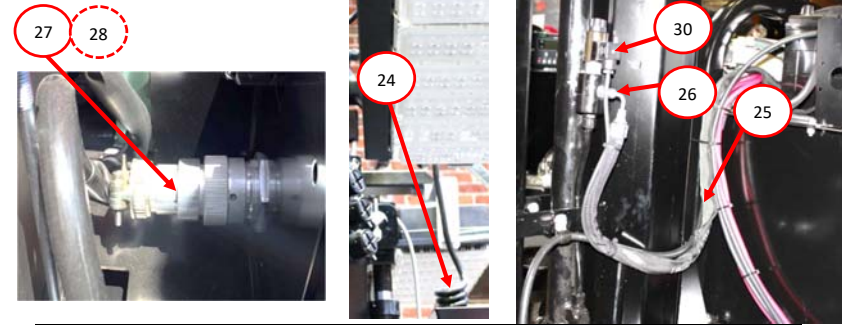
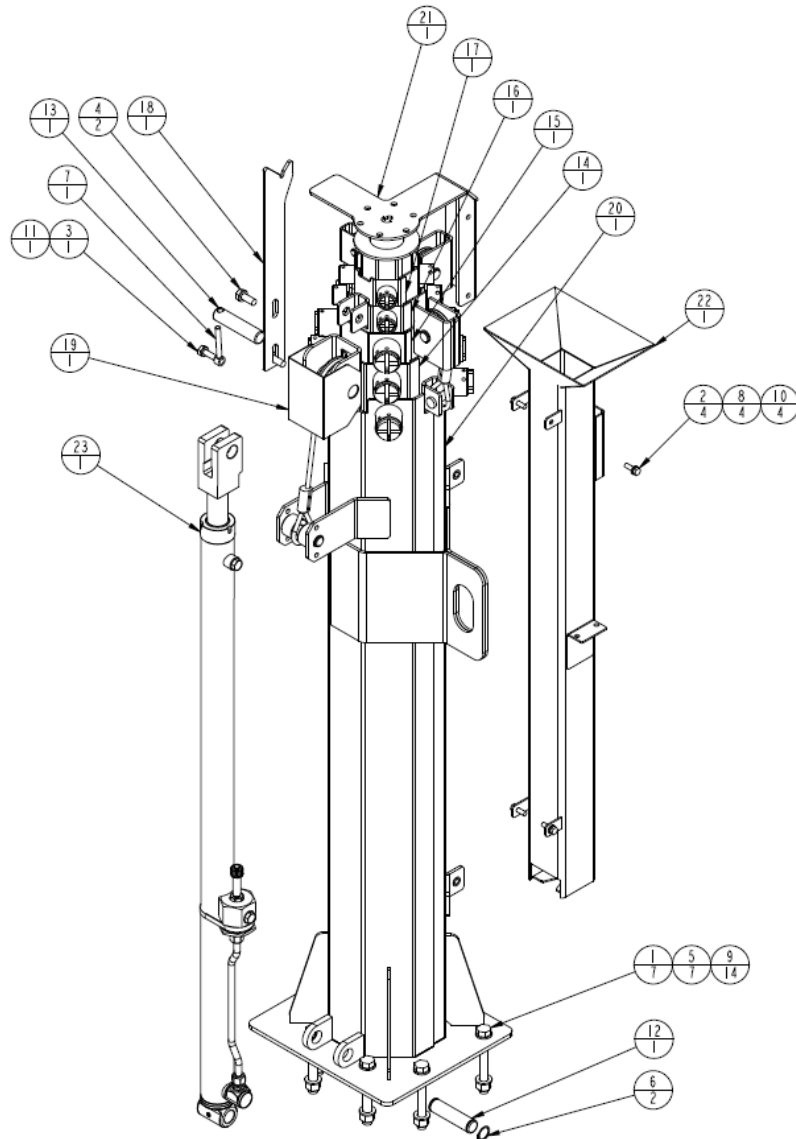

SEQ.#	ITEM NO.	DESCRIPTION	QTY
1	0701630	HEX HEAD BOLT, M16 X 130 CLASS 8.8	7
2	0760812	HEX HEAD BOLT, M8 X 25 CLASS 8.8	4
3	0761014	HEX HEAD BOLT, M10 X 30 CLASS 8.8	1
4	0761214	HEX HEAD BOLT, M12 X 30 CLASS 8.8	2
5	3291605	HEX LOCK NUT, M16 X 2 CLASS 8	7
6	7011716	RING, RETAINING 1.0"	2
7	3841143	KEEPER, 3/8" SHAFT	1
8	4811900	WASHER, 8 mm	4
9	4812300	WASHER, 16 mm	14
10	4831900	LOCKWASHER, SPRING 8 mm	4
11	4832000	LOCKWASHER, SPRING 10 mm	1
12	1001159483	PIN, CYLINDER CLEVIS	1
13	1001201580	PIN, MAST CYLINDER SHEAVE	1
14	1001201582	MAST, LT WELDMENT SECTION 2	1
15	1001201778	MAST, LT WELDMENT SECTION 3	1
16	1001201783	BOOM, LT WELDMENT SECTION 4	1
17	1001201794	MAST, LT WELDMENT SECTION 5	1
18	1001209969	PLATE, LIGHTHEAD STABILITY	1
19	1001218855	COVER, MAST CABLE	1
20	1001278809	MAST, WELDMENT SECTION 1	1
21	1001278812	MAST, LT WELDMENT SECTION 6	1
22	1001278896	SUPPORT, WELDMENT CURLY CORD	1
23	1001282255	CYLINDER, HYDRAULIC	1
24	1001214489	CABLE, COILED CORD	1
25	1001203248	HOSE ASSY, METRO LIFT CYLINDER	1
26	2220582	FTG 9/16 UNO X 7/16 JIC NIPP	1
27	4460754	CONNECTOR, HD SERIES PLUG	1
28	4460464	TERMINAL, DEUTSCH #16 - #18 PIN	12
29	1001161887	KIT, CYLINDER SEAL (NOT SHOWN)	1
30	1001299650	VALVE, SOLENOID MAIN CYLINDER	1

**MAST SECTION 1**

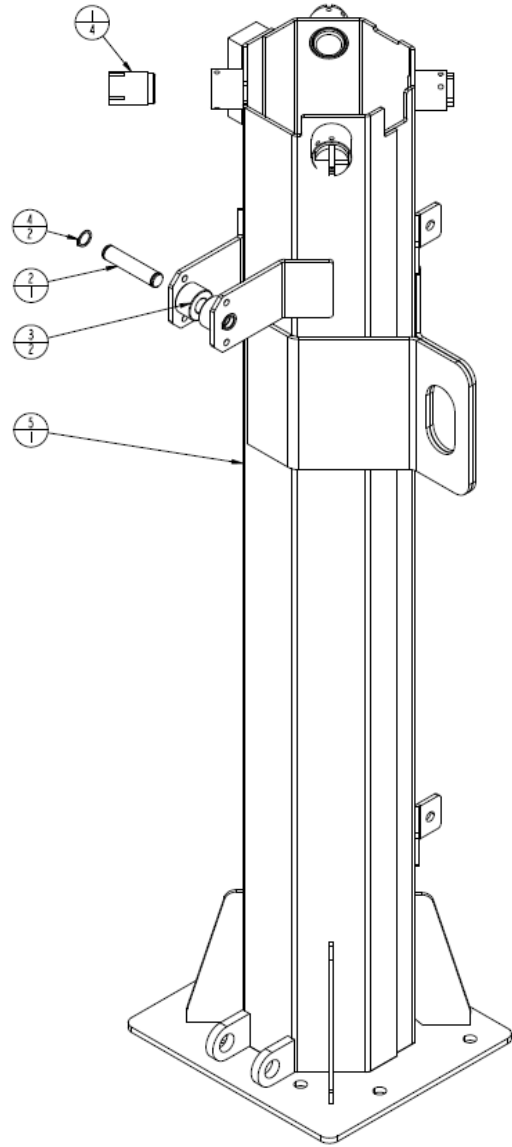

SEQ.#	ITEM NO.	DESCRIPTION	QTY
1	1001228793	PAD, 1.25" BSPP MAST WEAR	4
2	1001159482	PIN, LUG S1	1
3	1001159883	SHIM, MAST LUG, S1	2
4	1001160214	RING, RETAINING EXT, 0.75"	2
5	1001278809	MAST, WELDMENT SECTION 1	1

MAST SECTION 2

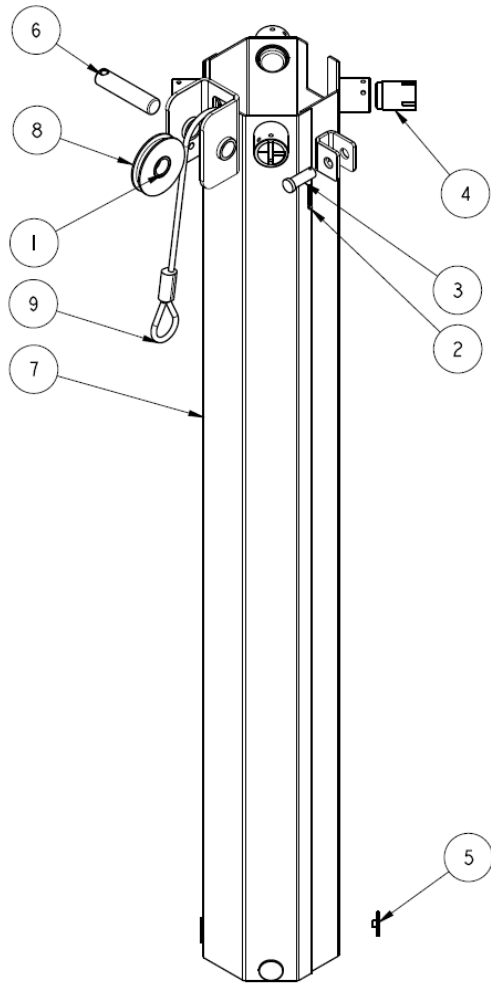

SEQ.#	ITEM NO.	DESCRIPTION	QTY
1	0961947	BEARING, GARMAX - 1 ID	1
2	3391410	PIN, SPLIT 4 X 30 mm	1
3	3431014	PIN, FLAT HEAD CLEVIS	1
4	1001228793	PAD, 1.25" BSPP MAST WEAR	4
5	1001159498	PAD, INNER 4 mm	4
6	1001201580	PIN, MAST CYLINDER SHEAVE	1
7	1001201582	MAST, LT WELDMENT SECTION 2	1
8	1001204659	SHEAVE, MAST CYL 92 mm DIA.	1
9	1001204568	CABLE, LT MAST S1-3 (CONNECT S3 LOWER POINT AND S1 TOP POINT)	1

**MAST SECTION 3**

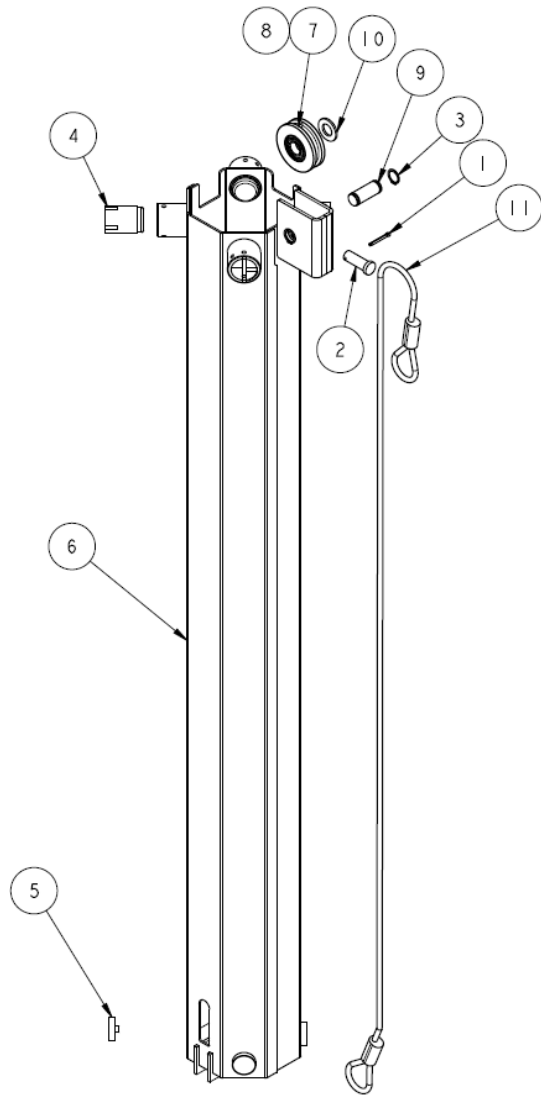

SEQ.#	ITEM NO.	DESCRIPTION	QTY
1	3391410	PIN, SPLIT 4 X 30 mm	2
2	3431014	PIN, FLAT HEAD CLEVIS	2
3	3760488	RING, RETAINING EXT M20	2
4	1001228793	PAD, 1.25" BSPP MAST WEAR	4
5	1001159496	PAD, INNER 10 mm	4
6	1001201778	MAST, LT WELDMENT SECTION 3	1
7	1001204172	SHEAVE, LT MAST 80 DIA	1
8	1001207844	BEARING, BALL, 20 X 42 X 12 mm	2
9	1001207845	PIN, DIA 20, MAST SHEAVE	1
10	1001208673	WASHER-SPEC, NYLON, M20 X 37 X 3 mm	2
11	1001204569	CABLE, LT MAST S2-4 (CONNECT S4 LOWER POINT AND S2 TOP POINT)	1

MAST SECTION 4

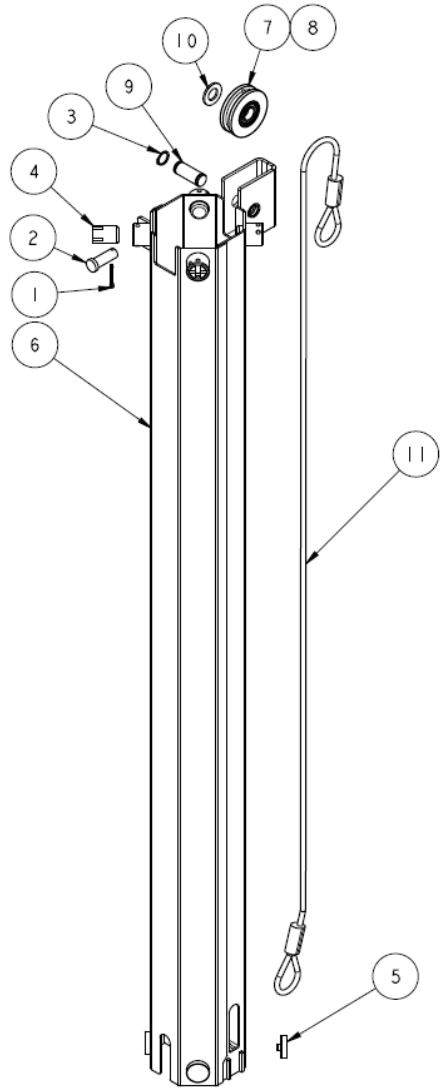

SEQ.#	ITEM NO.	DESCRIPTION	QTY
1	3391410	PIN, SPLIT 4 X 30 mm	2
2	3431014	PIN, FLAT HEAD CLEVIS	2
3	3760488	RING, RETAINING EXT M20	2
4	1001228794	PAD, 0.75" BSPP MAST WEAR	4
5	1001159496	PAD, INNER 10 mm	4
6	1001201783	BOOM, LT WELDMENT SECTION 4	1
7	1001204172	SHEAVE, LT MAST 80 DIA	1
8	1001207844	BEARING, BALL, 20 X 42 X 12 mm	2
9	1001207845	PIN, DIA 20, MAST SHEAVE	1
10	1001208673	WASHER-SPEC, NYLON, M20 X 37 X 3 mm	2
11	1001204569	CABLE, LT MAST S3-5 (CONNECT S5 LOWER POINT AND S3 TOP POINT)	1

**MAST SECTION 5**

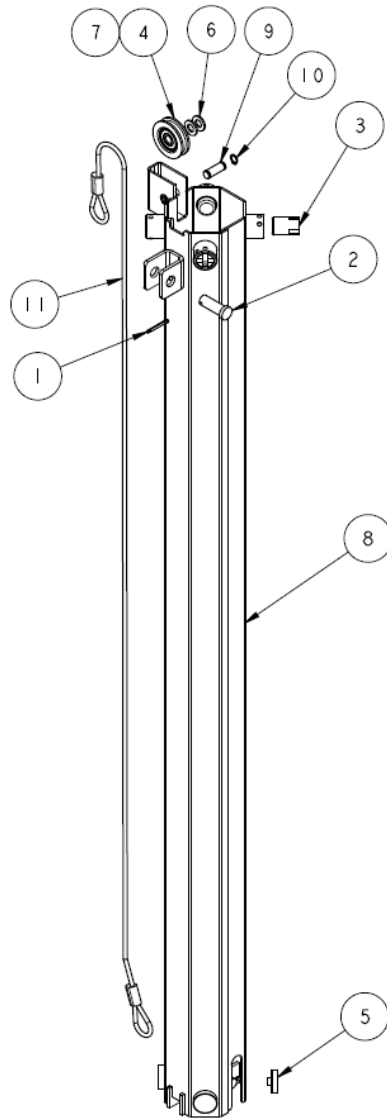

SEQ.#	ITEM NO.	DESCRIPTION	QTY
1	3391410	PIN, SPLIT 4 X 30 mm	2
2	3431014	PIN, FLAT HEAD CLEVIS	2
3	1001228794	PAD, 0.75" BSPP MAST WEAR	4
4	1001159479	SHEAVE, 60 mm	1
5	1001159496	PAD, INNER 10 mm	4
6	1001160216	WASHER, NYLON, 12 mm	4
7	1001160923	BEARING, NTN 6301LLU	1
8	1001201794	MAST, LT WELDMENT SECTION 5	1
9	1001207846	PIN, DIA 12, MAST SHEAVE	1
10	1001209642	RING, RETAINING EXT. 12 mm DIA	2
11	1001204570	CABLE, LT MAST S4-6 (CONNECT S6 LOWER POINT AND S4 TOP POINT)	1

**MAST SECTION 6**

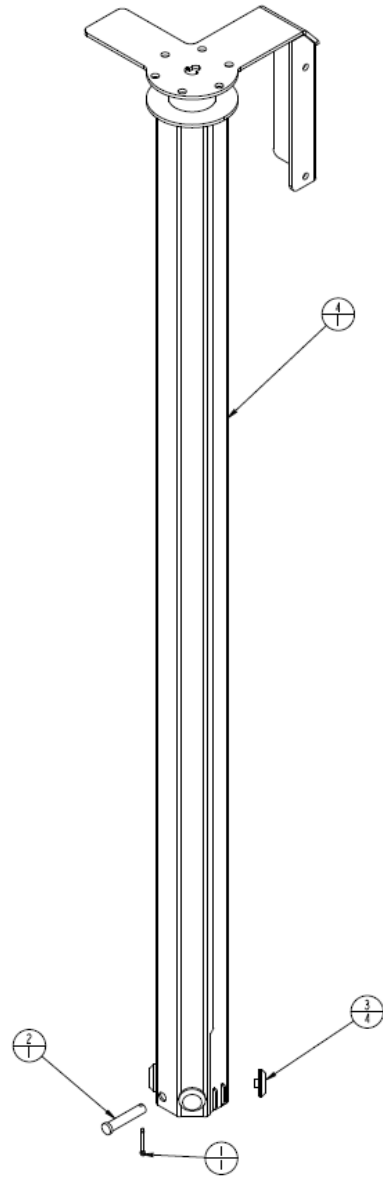

SEQ.#	ITEM NO.	DESCRIPTION	QTY
1	3391410	PIN, SPLIT 4 X 30 mm	1
2	3430810	PIN, FLAT HEAD CLEVIS	1
3	1001159496	PAD, INNER 10 mm	4
4	1001278812	MAST, LT WELDMNT SECTION 6	1

# JLG LT<sup>3</sup> LIGHT HEAD

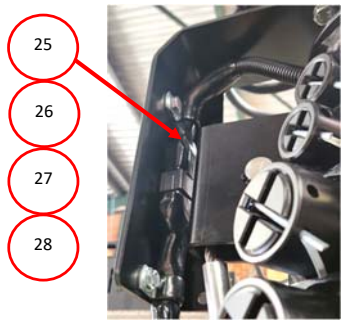
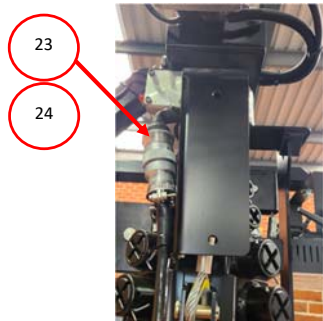
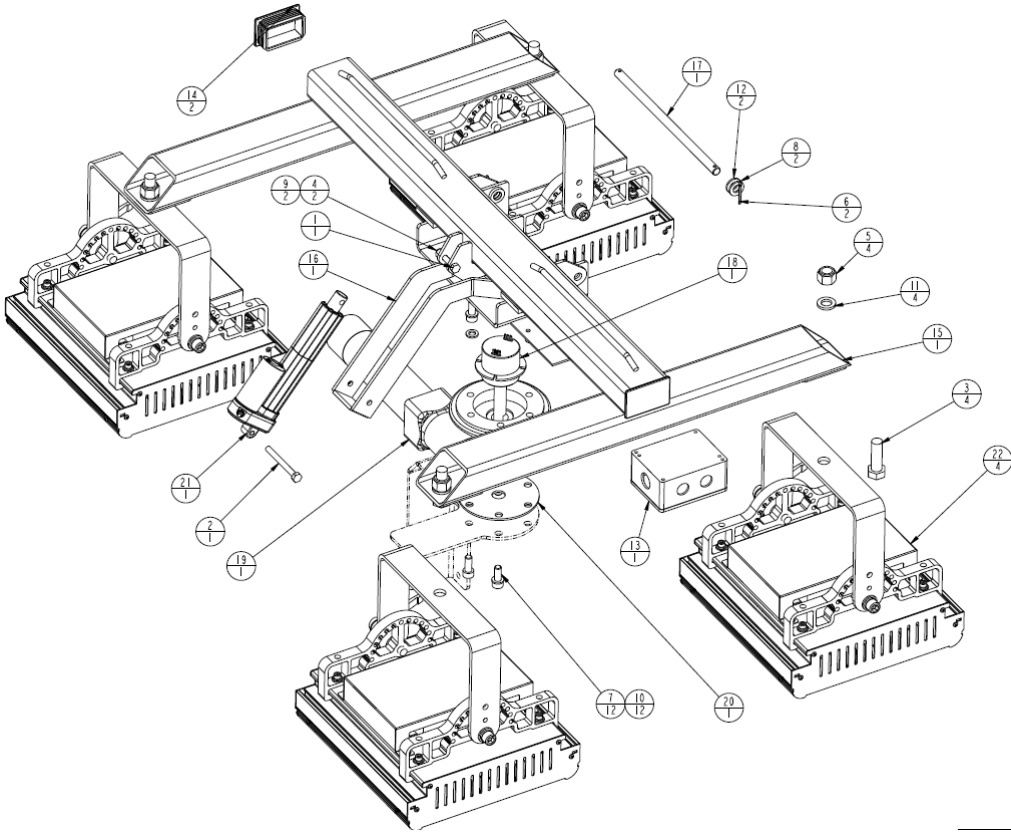

# JLG LT<sup>3</sup>

SEQ.#	ITEM NO.	DESCRIPTION	QTY
1	0760817	HEX HEAD BOLT, M8 X 45 CLASS 8.8	1
2	0760824	HEX HEAD BOLT, M8 X 80 CLASS 8.8	1
3	0701620	HEX HEAD BOLT, M16 X 60 CLASS 8.8	4
4	3290805	HEX LOCK NUT, M8 X 1.25 CLASS 8	2
5	3291605	HEX LOCK NUT, M16 X 2 CLASS 8	4
6	3391210	PIN, SPLIT 3.2 X 30 mm	2
7	0761012	HEX HEAD BOLT, M10 X 25 CLASS 8.	12
8	4812100	WASHER, 12 mm	2
9	4831900	LOCKWASHER, SPRING 8 mm	2
10	4832000	LOCKWASHER, SPRING 10 mm	12
11	4812300	WASHER, 16 mm	8
12	1001160216	WASHER, NYLON, 12 mm	2
13	1001205374	BOX, MAST JUNCTION METRO	1
14	1001215796	PLUG, PLASTIC INTERNAL 75 X 50 mm	2
15	1001278819	SUPPORT, LIGHTS LIGHT TOWER	1
16	1001278878	BRACKET, ASSY LIGHT HEAD PIVOT	1
17	1001278901	PIN, LIGHTHEAD PIVOT	1
18	1001278902	SLIP RING, 10A 12 WIRE	1
19	1001278903	MOTOR, SLEW DRIVE 48V DC	1
20	1001287788	PLATE, SLEW DRIVE PACKER	1
21	1001236015	ACTUATOR, ELECTRIC, 150KG	2
22	1001273102	LAMP, LED 48VDC 300W	4
23	4460754	FEMALE PLUG 14 PIN (BEFORE S/N:LT30000131)	1
24	4461016	TERMINAL (BEFORE S/N:LT30000131)	1
25	44608365	TERMINAL, CONN 12 POS PLUG BLK (AFTER S/N:LT30000131)	1
26	44609505	TERMINAL, CONNECTOR HOUSING 12 (AFTER S/N:LT30000131)	1
27	1001308455	BOOT, DEUTSCH CONN 120MM BLACK (AFTER S/N:LT30000131)	1
28	1001308454	BOOT, DEUTSCH BLK SOC 120MM BLK (AFTER S/N:LT30000131)	1



JLG LT<sup>3</sup>

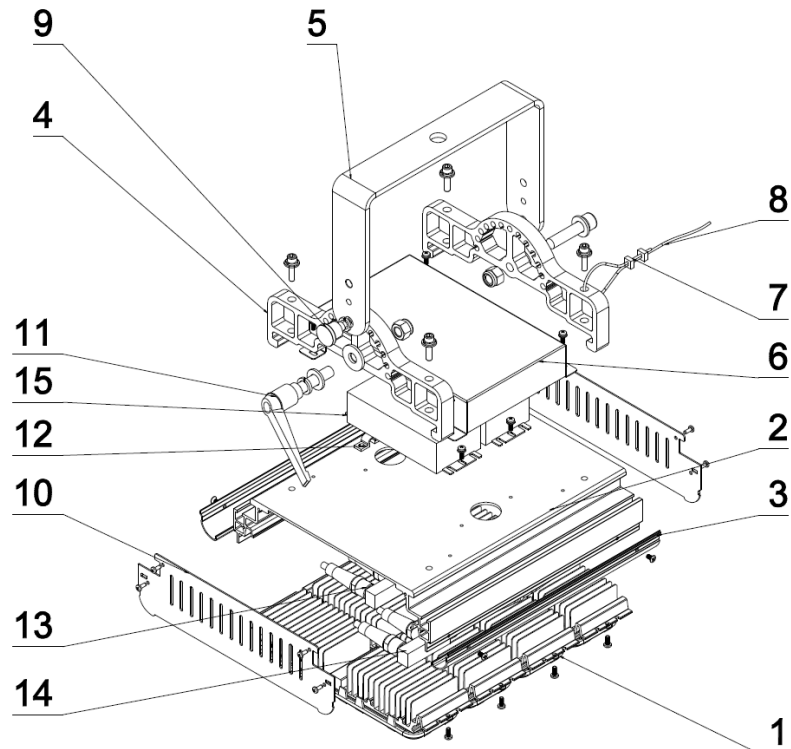

SEQ.#	ITEM NO.	DESCRIPTION	QTY
1	1001281346	LAMP, MODULE M28S8-VDE 300W	4
2	1001289271	LAMP, 4M-DFZ HOUSING 300W	1
3	1001289272	LAMP, 4M-B TRIM 300W	2
4	1001289273	LAMP, BRIDGE BRACKET 300W	2
5	1001289274	LAMP, TRUNION BRACKET 300W	1
6	1001289275	LAMP, 4MDF DRIVER COVER 300W	1
7	1001289279	LAMP, CABLE DOP 300W	4
8	1001289280	LAMP, WIREROPE 300W	1
9	1001281351	LAMP, M10 INDEX PLUNGER PIN	1
10	1001289276	LAMP, SIDE PLATE-B 300W	2
11	1001281350	LAMP, 7 STYLE HANDLE M12-300W	1
12	1001289281	LAMP, PRESSING LINE PLATE 300W	1
13	1001281347	LAMP, WIRE HARNESS 300W	2
14	1001281348	LAMP, WIRE HARNESS 300W	1
15	1001281349	LAMP, DRIVE POWER 48V-150DN-100	2

JLG LT<sup>3</sup>  
ELECTRICAL ASSEMBLY

AUTO CONTROL

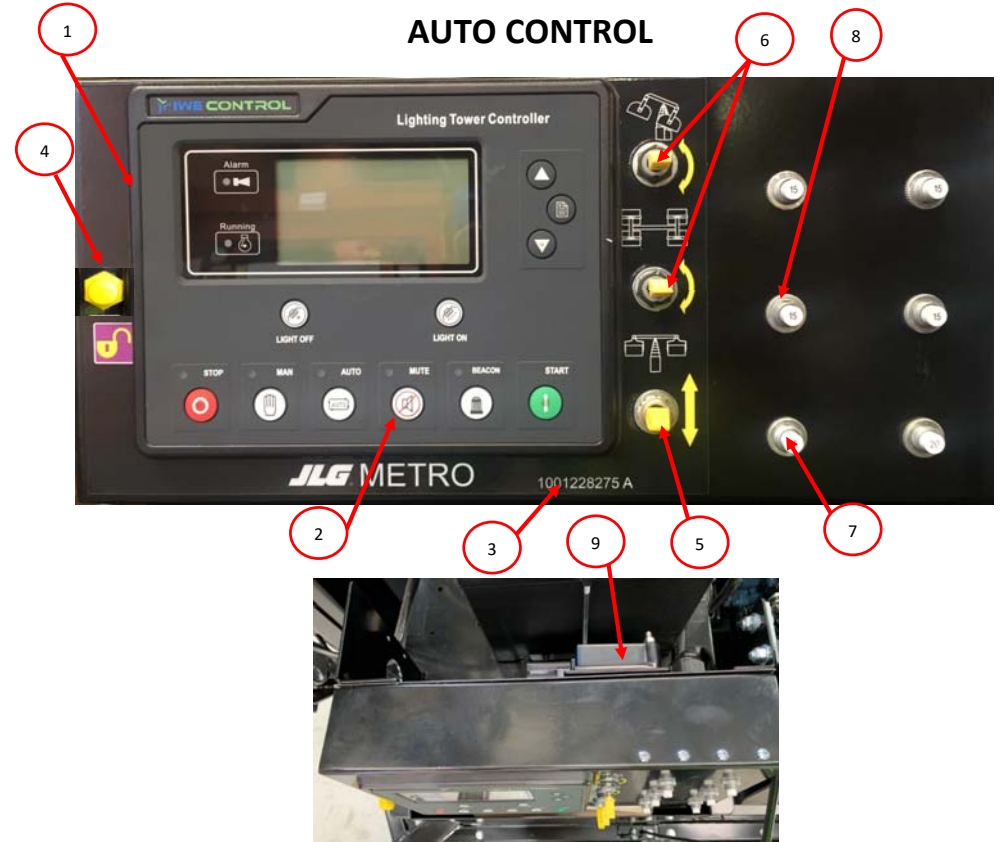

SEQ.#	ITEM NO.	DESCRIPTION	QTY
1	1001278801	KIT, CONTNTL BOX LT3	1
-	1001218500	BOX, CONTROL AUTO METRO LED	1
-	1001278802	PLATE, CONTROL BOX AUTO METRO LED (NOW SHOWN)	1
2	1001209453	CONTROL, LED LT ENGINE AUTO	1
3	1001228275	DECAL, METRO LED AUTO START	1
4	4360387	SWITCH, PUSH BUTTON	1
5	4360328	SWITCH, TOGGLE	1
6	4360314	SWITCH, TOGGLE	2
7	4360161	SWITCH, CIRCUIT BREAKER 20 A	1
8	4360070	SWITCH, CIRCUIT BREAKER 15 A	5
9	1001265718	CONTROL, ECU 1500 RPM Z482 EG	1
10	1001293075	FUSE, 5A MINI 58VDC (NOT SHOWN)	1

DECAL AND MISCELLANEOUS

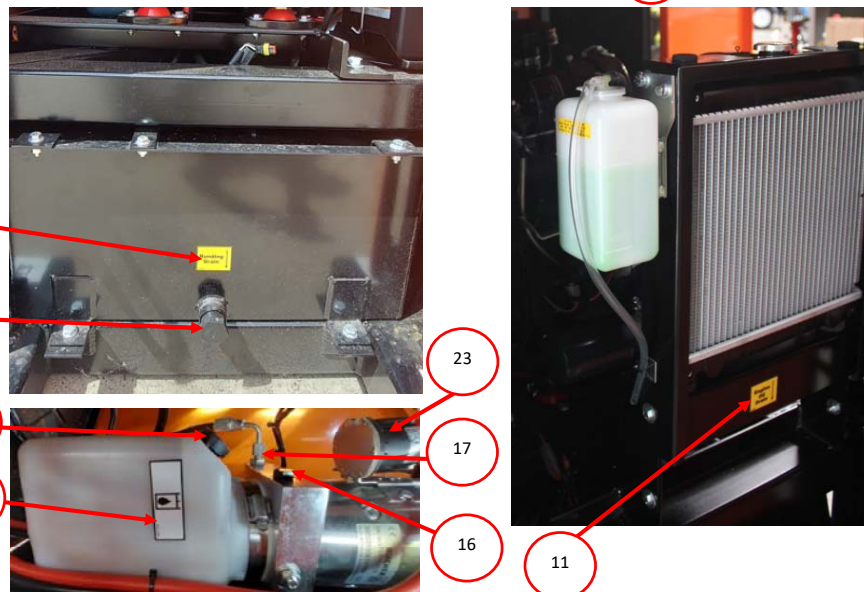

1001309468\_C

SEQ.#	ITEM NO.	DESCRIPTION	QTY
1	1702009	DECAL, JLG BLACK 3.25"	4
2	1001278925	DECAL, LT3	2
3	1702300	DECAL, TIE DOWN	4
4	1703073	DECAL, FORK LIFT POINT	8
5	1701785	DECAL, DANGER	4
6	1001159774	DECAL, DANGER TIPPING/ELEC LT	1
7	1701505	DECAL, FUEL	1
8	1700037	DECAL, GROUND CONTROL	1
9	1701500	DECAL, TIE DOWN/LIFT	2
10	1001159775	DECAL, BUNDING DRAIN	1
11	1001159777	DECAL, ENGINE OIL DRAIN	1
12	1001159780	DECAL, HYDRAULIC OIL	1
13	1001207748	DECAL, HYDRAULIC PRESSURE 12.5 MPa (not shown)	1
14	1001218636	DECAL, CAUTION, STAND CLEAR OF MAST	1
15	1001222555	DECAL, CONTROLLER PWR SAVE MODE	1
16	2220237	FITTING 9/16" UNO PLUG	2
17	70000642	CARTRIDGE 2W/2P W/O COIL	1
18	1001204664	PLUG, 1" BSPT PLASTIC	1
19	1001233162	DECAL, D&M	2
20	8990147	HOLDER, MANUAL	1
21	1701640	DECAL MANUAL	1
22	70001025	CAP, RESERVOIR FILL	1
23	70045064	SOLENOID, 12V APU	1

1001309468\_C

**RECOMMENDED SPARES**

ITEM DESCRIPTION	PART NO.
FAN, BELT KUBOTA Z482 EG	1001265321
HOSE, RADIATOR TOP Z482 EG	1001265320
HOSE, RADIATOR BOTTOM Z482 EG	1001265317
FILTER, AIR KUBOTA Z482	1001212174
FUEL FILTER	1730930
FILTER, OIL Z482 EG	1001265352
FILTER, WATER SEPARATOR Z482	1001212180
FILTER FUEL IN LINE	7017992
VALVE, FUEL ONE WAY	1001265717
SWITCH, CIRCUIT BREAKER 20 A	4360161
FUSE, 30 AMP	8229245
FUSE, 5A MINI 58VDC	1001293075
HOLDER,FUSHF-011 M205SC IN-LINE	1001312648
FUSE,FUSMP205-1A 250V CFF (ENG. SPEED SENSOR)	1001312647
SWITCH, CIRCUIT BREAKER 15 A	4360070
RELAY	1001171585
CONTROLLER, LED LT ENGINE AUTO	1001209453
SEALING WASHER, 3/8UNC 750 SERIES HYDRAULIC POWERPACK PRESSURE RELIEF VALVE ADJUSTING SCREW	1001246647
VALVE, SOLENOID FOR MAST HYDRAULIC CYLINDER (1001282255)	1001295296
VALVE, SOLENOID FOR MAST HYDRAULIC CYLINDER (1001206341)	1001220712

**BLANK PAGE**